

6" 1500#

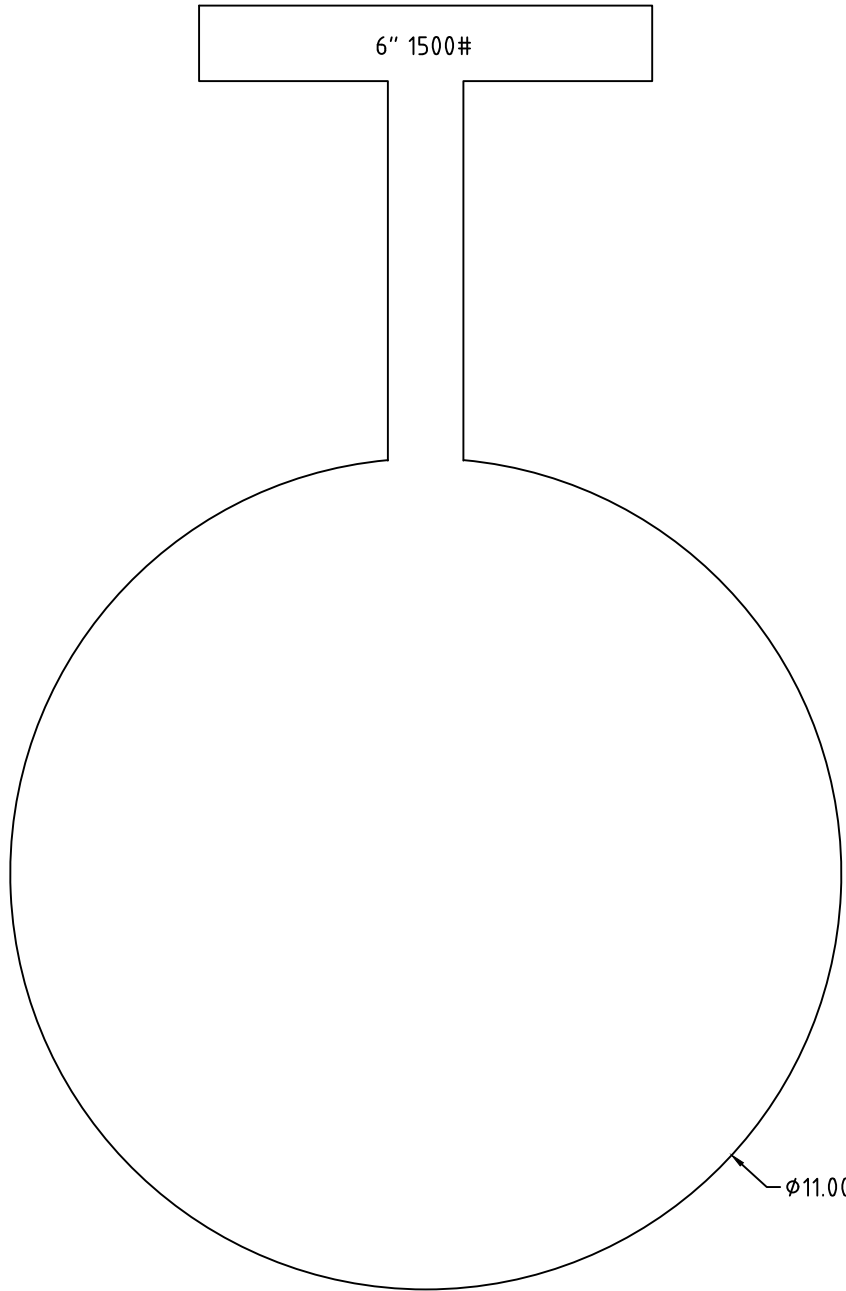

$\phi 11.00$

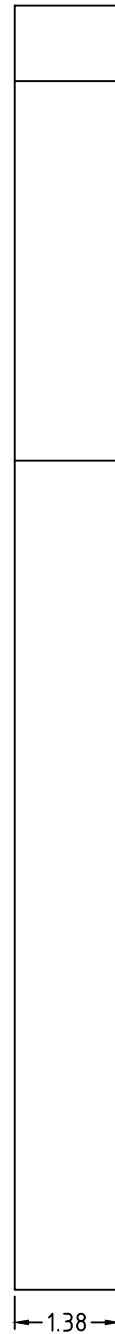

1.38

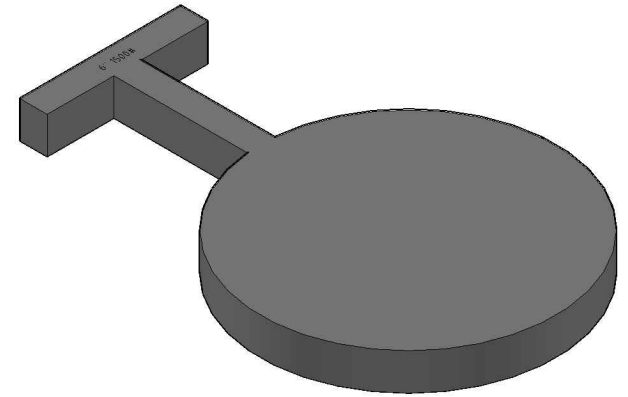

DIMENSIONS ASME B16.48
FACING TOLERANCES ASME B16.5
THICKNESS TOLERANCES (-ZERO +.12)

HYDROBLIND
SOLUTIONS

5500 TWIN CITY HWY.
PORT ARTHUR, TX 77642
(409) 736-7665

WWW.HYDROBLINDSOLUTIONS.COM

TITLE: 6" CLASS 1500 PADDLE BLIND T-HANDLE

MATERIAL: A516-70 / 304L / 316L

FINISH: MILL OR 125-250 AARH MACHINE

WEIGHT: 48 LBS